

TAPPI CILINDRICI

CYLINDRICAL PULL PLUGS

CPPA - SILICONE 315°C

Verniciatura a Polveri, Cataforesi, Anodizzazione,
Galvanica, Verniciatura a liquido.

Powder Coating, E-Coating, Anodizing, Electroplating, Wet Painting.

Adatti per mascherare fori passanti filettati e non filettati. Riutilizzabili.

To mask through holes, threaded and non-threaded. Reusable.

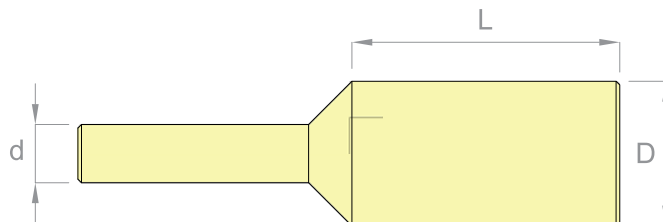

| Codice Part Number | Colore Color | Adatto per Suitable for | D (mm) | L (mm) | d (mm) | Confezione (pz) Unit/bag |
|-----------------------|-----------------|----------------------------|-----------|-----------|-----------|-----------------------------|
| CPPA.0035 | ⊘ | - | 0,90 | 19,10 | 0,60 | 1000 |
| CPPA.0042 | ⊘ | - | 1,10 | 12,70 | 0,60 | 1000 |
| CPPA.0050 | ⊘ | - | 1,30 | 12,70 | 0,60 | 1000 |

| Codice Part Number | Colore Color | Adatto per Suitable for | D (mm) | L (mm) | d (mm) | Confezione (pz) Unit/bag |
|-----------------------|-----------------|----------------------------|-----------|-----------|-----------|-----------------------------|
| CPPA.06 | ⊘ | - | 1,57 | 9,50 | 1,20 | 1000 |
| CPPA.0065 | ⊘ | - | 1,60 | 12,70 | 1,00 | 1000 |
| CPPA.07-500 | ⊘ | - | 1,70 | 12,70 | 1,00 | 1000 |
| CPPA.07 | ⊘ | - | 1,70 | 15,88 | 1,19 | 1000 |
| CPPA.08 | ⊘ | M2 | 1,85 | 15,88 | 1,20 | 1000 |
| CPPA.08A | ⊘ | - | 2,00 | 25,40 | 1,00 | 1000 |
| CPPA.09 | ⊘ | - | 2,31 | 15,88 | 1,20 | 1000 |
| CPPA.010C | ⊘ | - | 2,36 | 15,88 | 1,57 | 1000 |
| CPPA.010B | ⊘ | - | 2,41 | 25,40 | 1,32 | 1000 |
| CPPA.010A | ⊘ | - | 2,67 | 25,40 | 1,80 | 1000 |
| CPPA.011 | ⊘ | M3 | 2,77 | 25,40 | 1,57 | 1000 |
| CPPA.011-500 | ● | M3 | 2,77 | 15,88 | 1,57 | 500 |
| CPPA.011B | ⊘ | - | 3,00 | 25,40 | 2,08 | 500 |
| CPPA.011A | ○ | - | 3,18 | 15,88 | 2,08 | 500 |
| CPPA.014-500 | ⊘ | - | 3,30 | 15,88 | 2,08 | 500 |
| CPPA.014 | ⊘ | - | 3,30 | 25,40 | 2,40 | 500 |
| CPPA.015-750 | ⊘ | - | 3,30 | 16,50 | 2,36 | 500 |
| CPPA.015 | ⊘ | - | 3,30 | 25,40 | 2,00 | 500 |
| CPPA.017 | ● | M4 | 3,56 | 15,87 | 2,08 | 500 |
| CPPA.017D | ⊘ | - | 3,70 | 31,75 | 2,40 | 500 |
| CPPA.018 | ⊘ | - | 3,91 | 15,88 | 2,08 | 500 |
| CPPA.020A | ⊘ | - | 3,96 | 15,88 | 2,08 | 500 |
| CPPA.020 | ⊘ | - | 4,00 | 19,10 | 1,60 | 500 |
| CPPA.021D | ⊘ | - | 4,00 | 31,75 | 2,08 | 500 |
| CPPA.021 | ⊘ | - | 4,00 | 25,40 | 2,40 | 500 |
| CPPA.022A | ⊘ | - | 4,10 | 19,80 | 3,00 | 500 |
| CPPA.022 | ● | - | 4,10 | 15,88 | 2,44 | 500 |
| CPPA.022D | ⊘ | - | 4,50 | 31,75 | 2,40 | 500 |
| CPPA.024 | ● | M5 | 4,75 | 15,88 | 2,80 | 500 |
| CPPA.025 | ○ | M5 | 4,95 | 15,88 | 2,80 | 500 |
| CPPA.026-500 | ⊘ | - | 5,00 | 15,88 | 2,80 | 500 |
| CPPA.026 | ● | - | 5,00 | 25,40 | 2,80 | 500 |
| CPPA.030 | ⊘ | M6 | 5,54 | 25,40 | 3,30 | 500 |
| CPPA.030D | ⊘ | M6 | 5,54 | 31,75 | 3,30 | 500 |
| CPPA.033 | ● | M6 | 5,72 | 25,40 | 3,18 | 500 |
| CPPA.035D | ⊘ | - | 6,00 | 31,75 | 3,20 | 500 |
| CPPA.035A | ● | - | 6,00 | 10,20 | 4,50 | 500 |
| CPPA.036D | ⊘ | - | 6,40 | 31,75 | 3,20 | 500 |
| CPPA.037 | ● | - | 6,53 | 25,40 | 3,30 | 500 |
| CPPA.039D | ⊘ | - | 6,70 | 31,75 | 3,20 | 500 |
| CPPA.040 | ⊘ | - | 6,99 | 24,13 | 3,30 | 500 |
| CPPA.40D | ⊘ | - | 6,99 | 50,80 | 3,70 | 500 |
| CPPA041 | ● | M8 | 7,14 | 25,40 | 3,30 | 500 |
| CPPA041D | ⊘ | M8 | 7,14 | 31,75 | 3,20 | 500 |
| CPPA.042 | ⊘ | M8 | 7,92 | 25,40 | 3,73 | 500 |
| CPPA.042D | ⊘ | - | 7,92 | 31,75 | 4,80 | 500 |
| CPPA.042 | ⊘ | - | 8,00 | 25,40 | 3,90 | 500 |

| Codice Part Number | Colore Color | Adatto per Suitable for | D (mm) | L (mm) | d (mm) | Confezione (pz) Unit/bag |
|-----------------------|-----------------|----------------------------|-----------|-----------|-----------|-----------------------------|
| CPPA.042D | ⊘ | - | 8,18 | 28,58 | 6,40 | 500 |
| CPPA.043 | ○ | - | 8,51 | 25,40 | 3,99 | 500 |
| CPPA.043B | ⊘ | - | 8,51 | 27,90 | 6,40 | 500 |
| CPPA.045 | ⊘ | - | 8,89 | 22,86 | 4,00 | 500 |
| CPPA.045D | ⊘ | M10 | 8,89 | 31,75 | 4,80 | 500 |
| CPPA.050 | ⊘ | - | 9,53 | 31,75 | 4,80 | 500 |
| CPPA.055 | ⊘ | - | 9,75 | 25,40 | 3,90 | 500 |
| CPPA.056 | ⊘ | - | 9,86 | 25,40 | 4,00 | 200 |
| CPPA.058 | ⊘ | - | 10,16 | 25,40 | 4,00 | 200 |
| CPPA.059 | ⊘ | - | 10,30 | 31,75 | 6,40 | 200 |
| CPPA.060 | ⊘ | - | 10,36 | 25,40 | 4,90 | 200 |
| CPPA.063 | ⊘ | M12 | 10,52 | 25,40 | 4,00 | 200 |
| CPPA.064 | ⊘ | - | 11,10 | 31,75 | 6,40 | 200 |
| CPPA.065 | ● | - | 11,18 | 25,40 | 4,00 | 200 |
| CPPA.067 | ⊘ | - | 11,30 | 25,40 | 6,48 | 200 |
| CPPA.070 | ⊘ | - | 11,89 | 25,40 | 6,35 | 200 |
| CPPA.071D | ⊘ | - | 11,89 | 31,75 | 6,35 | 200 |
| CPPA.073 | ⊘ | - | 12,00 | 25,40 | 6,20 | 200 |
| CPPA.074 | ⊘ | M14 | 12,70 | 25,40 | 6,40 | 200 |
| CPPA.074D | ⊘ | M14 | 12,70 | 31,75 | 6,40 | 200 |
| CPPA.077 | ⊘ | - | 12,95 | 25,40 | 6,40 | 200 |
| CPPA.078 | ⊘ | - | 13,10 | 31,75 | 6,40 | 200 |
| CPPA.080 | ● | - | 13,46 | 25,40 | 6,35 | 200 |
| CPPA.081B | ⊘ | - | 13,50 | 31,75 | 6,40 | 200 |
| CPPA.0570 | ⊘ | - | 14,48 | 25,40 | 7,70 | 100 |
| CPPA.087 | ● | M16 | 15,54 | 25,40 | 6,35 | 100 |
| CPPA.087B | ⊘ | M16 | 15,54 | 38,10 | 6,40 | 100 |
| CPPA.090 | ⊘ | - | 16,26 | 25,40 | 9,53 | 100 |
| CPPA.081 | ⊘ | M18 | 16,26 | 38,10 | 6,40 | 100 |
| CPPA.095 | ⊘ | M20 | 17,78 | 25,40 | 9,50 | 100 |
| CPPA.095B | ⊘ | - | 17,78 | 38,10 | 6,40 | 100 |
| CPPA.096 | ⊘ | - | 18,00 | 50,80 | 9,50 | 100 |
| CPPA.097 | ⊘ | - | 18,50 | 25,40 | 7,90 | 100 |
| CPPA.0100 | ○ | - | 19,56 | 28,57 | 9,50 | 100 |
| CPPA.0100B | ⊘ | - | 19,56 | 38,10 | 6,40 | 100 |
| CPPA.0809 | ● | - | 20,55 | 25,40 | 8,00 | 50 |
| CPPA.0809B | ⊘ | - | 20,55 | 38,10 | 6,40 | 50 |
| CPPA.0110 | ● | - | 22,76 | 25,40 | 8,53 | 50 |
| CPPA.0110B | ⊘ | - | 22,76 | 38,10 | 6,40 | 50 |
| CPPA.0120 | ⊘ | - | 25,91 | 25,40 | 9,53 | 50 |
| CPPA.0120B | ⊘ | - | 25,91 | 38,10 | 9,53 | 50 |
| CPPA.0130 | ⊘ | - | 35,05 | 25,40 | 12,70 | 50 |
| CPPA.0130B | ⊘ | - | 35,05 | 38,10 | 18,60 | 50 |

Per una perfetta mascheratura:
la misura "D" del tappo dovrà essere piu' grande del 4% rispetto al diametro del foro da mascherare.

For a perfect masking:
Select the large plug diameter "D" 4% larger than the hole diameter..

.....