

CAPPUCCIO A VITE IN METALLO SCREW CAPS

MTA

Materiale: acciaio S235 JR, zincato.

Material: steel S235 JR, galvanised.

Filettatura metrica e foro per l'aggancio .
Appensione e mascheratura combinate.

Screw caps are designed for holding components with metric external thread. Combined hanging and masking.

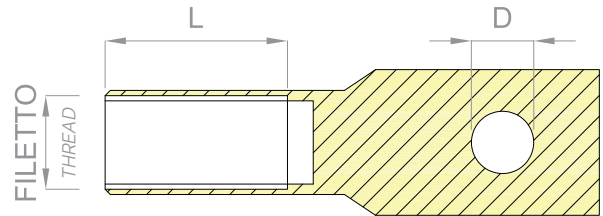

Codice Part Number	Adatto per Fits to thread	Lunghezza filettatura (mm) Thread length (mm)	Confezione (pz) Unit/bag
MTA-03	M3	5,00	500
MTA-04	M4	8,00	400
MTA-05	M5	13,00	200
MTA-06	M6	15,00	100
MTA-08	M8	15,00	50
MTA-10	M10	20,00	25
MTA-12	M12	25,00	25
MTA-14	M14	25,00	25
MTA-16	M16	25,00	25
MTA-18	M18	25,00	25
MTA-20	M20	25,00	25